



### 208 and 230 Volt

Qty.	Tag Numbers	HP	Frame Size	Drive Model	Nominal Voltage	Max. Amps Output* 40/50°C
		1.0	H1	TR150PK75T2	208-230	4.2/3.5
		2	H1	TR150P1K5T2	208-230	6.8/6.8
		3	H2	TR150P2K2T2	208-230	9.6/9.6
		5	H3	TR150P3K7T2	208-230	15.2/13
		7.5	H4	TR150P5K5T2	208-230	22/19.8
		10	H4	TR150P7K5T2	208-230	28/23
		15	H5	TR150P11K1T2	208-230	42/33
		20	H6	TR150P15K1T2	208-230	59.4/41.6
		25	H6	TR150P18K51T2	208-230	74.8/52.4
		30	H7	TR150P22K1T2	208-230	88/61.6
		40	H7	TR150P30K1T2	208-230	115/80.5
		50	H8	TR150P37K1T2	208-230	143/100.1
		60	H8	TR150P45K1T2	208-230	170/119

\*VFD HP/Amps may not necessarily match that of the motor.

### 460 Volt

Qty.	Tag Numbers	HP	Frame Size	Drive Model	Nominal Voltage	Max. Amps Output* 40/50°C
		1	H1	TR150PK75T4	460	2.1/1.8
		2	H1	TR150P1K5T4	460	3.4/3.4
		3	H2	TR150P2K2T4	460	4.8/4.4
		5	H2	TR150P3K7T4	460	8.2/7.5
		7.5	H3	TR150P5K5T4	460	11/10
		10	H3	TR150P7K5T4	460	14/12.6
		15	H4	TR150P11KT4	460	21/19.1
		20	H4	TR150P15KT4	460	27/24
		25	H5	TR150P18KT4	460	34/31.3
		30	H5	TR150P22KT4	460	40/35
		40	H6	TR150P30KT4	460	52/41.6
		50	H6	TR150P37KT4	460	65/52
		60	H6	TR150P45KT4	460	80/64
		70	H7	TR150P55KT4	460	105/73.5
		100	H7	TR150P75KT4	460	130/91
		125	H8	TR150P90KT4	460	160/112

VFD HP/Amps may not necessarily match that of the motor.

## 1

## 1.3.2 Dimensions

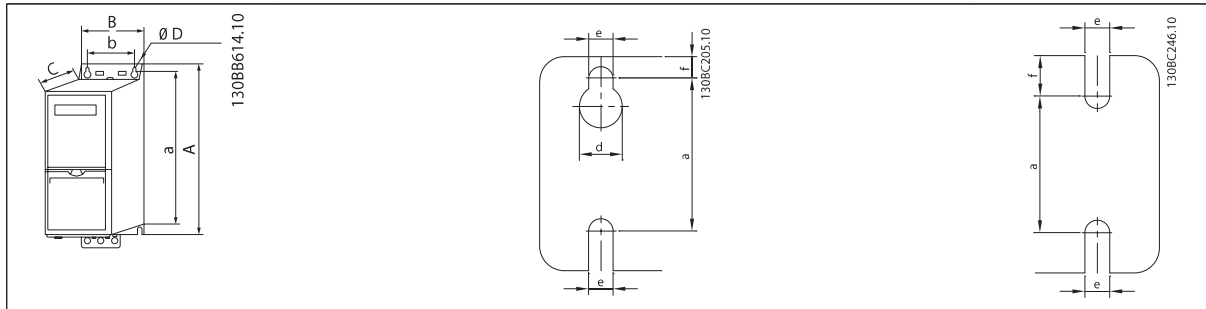

Enclosure		Power [kW]			Height [mm]			Width [mm]		Depth [mm]	Mounting hole [mm]			Max. Weight
Frame	IP Class	3x200-240 V	3x380-480 V	3x525-600 V	A	A <sup>1</sup>	a	B	b	C	d	e	f	kg
H1	IP20	0.25-1.5	0.37-1.5		195	273	183	75	56	168	9	4.5	5.3	2.1
H2	IP20	2.2	2.2-4.0		227	303	212	90	65	190	11	5.5	7.4	3.4
H3	IP20	3.7	5.5-7.5		255	329	240	100	74	206	11	5.5	8.1	4.5
H4	IP20	5.5-7.5	11-15		296	359	275	135	105	241	12.6	7	8.4	7.9
H5	IP20	11	18.5-22		334	402	314	150	120	255	12.6	7	8.5	9.5
H6	IP20	15-18.5	30-45	18.5-30	518	595/635 (45 kW)	495	239	200	242	-	8.5	15	24.5
H7	IP20	22-30	55-75	37-55	550	630/690 (75 kW)	521	313	270	335	-	8.5	17	36
H8	IP20	37-45	90	75-90	660	800	631	375	330	335	-	8.5	17	51
H9	IP20			2.2-7.5	269	374	257	130	110	205	11	5.5	9	6.6
H10	IP20			11-15	399	419	380	165	140	248	12	6.8	7.5	12

Table 1.4 Dimensions

<sup>1</sup> Including decoupling plate